

AVOP INFORMATION

AVOP Written Test

Time: Monday to Thursday, 0830 and 1500

Closed Fridays and statutory holidays

NEW Location: Terminal 1 International Arrivals level between terminal Entry/Exit doors D and E. Room number FB1039C.

Bring:

- Signed and completed AVOP Application Form (The form is available online at the web address below)
- Completed Certification Checklist – provided by your DA trainer
- RAIC
- Current AVOP card (if renewal)
- Pen (blue or black ink only)

Pass Office

Hours: Monday to Friday 0730 to 1700

Closed statutory holidays and every 2nd Thursday of the month

Location: T1 Parking Garage, Level 5

Contact: (416) 776-7277

Study Material

The Airports Traffic Directives, Airport Map (current Editions), AVOP Video and AVOP Application Form are available online at:

www.torontopearson.com/en/AVOP-program/#

*Online training materials are only accessible to authorized trainers. See the Cargo Training Department for additional study material and help.

* The required wait period for a failed written exam is as follows:

- **First attempt: 7 days**
- **Second attempt: 30 days (Renewal only)**

Updated DA Information in Airport Traffic Directives 2019:

- **Rolling stock staging lanes:** *White in color. Inside safety lines. No parking. For purpose of baggage staging/operations. (see pg.12)*
- **Aircraft Tail Overhang Markings** *are indicated by three broken orange lines, bordered by a solid white. They indicate a vehicle corridor that may be affected by the tail of an aircraft while gated. Although the speed limit in these areas remain 40 km/h, drivers encountering such vehicle corridors are to proceed with caution. (see pg.14)*
- **Vehicle Corridor Right-of-Way:** *New diagram added. (see pg. 32)*
- **Arriving Aircraft:** *Note: Visual Docking Guidance System (VDGS), may be activated (see pg.36)*
- **Escorting Vehicles:** *When encountering escorted vehicles, let the group or line of vehicles pass. Do not drive within the group. (see pg. 41 for paragraph add)*
- **Prohibited Parking Areas** - *within 1.5m of Primary Security Line (PSL) fence.*
 - - *Rolling stock staging lanes (see pg.43)*
- **Distraction, Task Saturation & Fatigue: Note:** *Permit holders may not drive more than 16 sixteen hours in any one shift without having an 8 hour break from vehicle operation. (see pg.51)*
- **Pedestrians: Note:** *Pedestrians shall not use the open apron as a short cut. Ramp employees should walk along terminal buildings. (see pg.54)*

Updated DA Information in Airport Traffic Directives 2019:

- *Vehicle corridors are marked in two ways: by parallel white lines or checkered white and black lines where the corridor crosses an apron entrance or aircraft stand taxi lane marking. (see pg.13, also pg.14 for connecting corridors)*
- *Aircraft Warning Sign indicates direction of aircraft travel. They are placed in vehicle corridors to alert drivers that they are about to cross a live aircraft stand taxi lane and to be extra vigilant. (see pg.18)*
- *Yield signs have been added to the yield lines in vehicle corridors identifying where drivers must yield to oncoming traffic. (see pg.18)*
- *Non-Passenger Screening for Vehicles (NPS-V) is a security regulation introduced by Transport Canada carried out by CATSA and may include inspection of the vehicle, its contents, as well as the driver for restricted items. (see pg.23-24)*
- *Parking Brake and Chocks: Equipment and vehicles that are running due to extreme weather conditions or operational reasons and left unoccupied must be in neutral or park, secured by functional parking break and be chocked. (see pg.39)*
- *Speed limit changes: Infield Tunnel **50km** (see pg.25)*
 - *Within 6m of a parked aircraft **10km** (see pg.25)*
 - *Terminal Service Roads **10km** (see pg.25)*

Points to Remember:

- Taxiway and Apron *edge* lights are **blue** whereas Taxiway and Apron *intersection* lights are **double amber**. (see pgs.16-17)
- Transiting between terminals: When transiting between terminal areas, *use the outer perimeter corridor*. Using the outer perimeter corridor minimizes traffic around the terminals. (see pgs.26-27)
- **Aircraft Tail Overhang Markings** are indicated by three broken **orange** lines, bordered by a solid white. They indicate a vehicle corridor that may be affected by the tail of an aircraft while gated. Although the speed limit in these areas remain 40 km/h, drivers encountering such vehicle corridors are to proceed with caution. (see pg.14)
-
- Designated Parking: Operators shall park vehicles and equipment on aprons and terminal service roads *within apron safety lines or designated parking spaces*. (see pg.39)
- **Rolling stock staging lanes**: White in color. Inside safety lines. **No parking**. For purpose of baggage staging/operations only (see pg.12)
-
- Driving under moveable bridges is prohibited. (pg.36)
- High visibility garments/safety vests must be worn airside when not in a closed cab vehicle (pg.51)
- **Signs of an Arriving flight:**
- A marshaller is in place
- A wingwalker(s) is in position
- Servicing equipment is staged
- Equipment is cleared to enable a safe aircraft docking
- **Visual Docking Guidance System (VDGS), may be activated**

Remember to read the questions and all answers carefully on the test. Don't Rush

Vehicle Corridor Right-of-way

Vehicles travelling in a connecting corridor, that crosses an aircraft stand taxilane, have right-of-way over vehicles that are established in the main corridor. Vehicles in the main corridor must stop at yield lines when yielding to vehicles in the connecting corridor. At the connection of two main corridors, the vehicle on the *right* has the right of way.

As these vehicles approach the intersection, vehicle **A** has right-of-way before **B** and **C**. Vehicle **B** will have next priority because it is on the right of vehicle **C**. Vehicles **B** and **C** give way to the aircraft as reminded by the *Aircraft Warning Sign*.

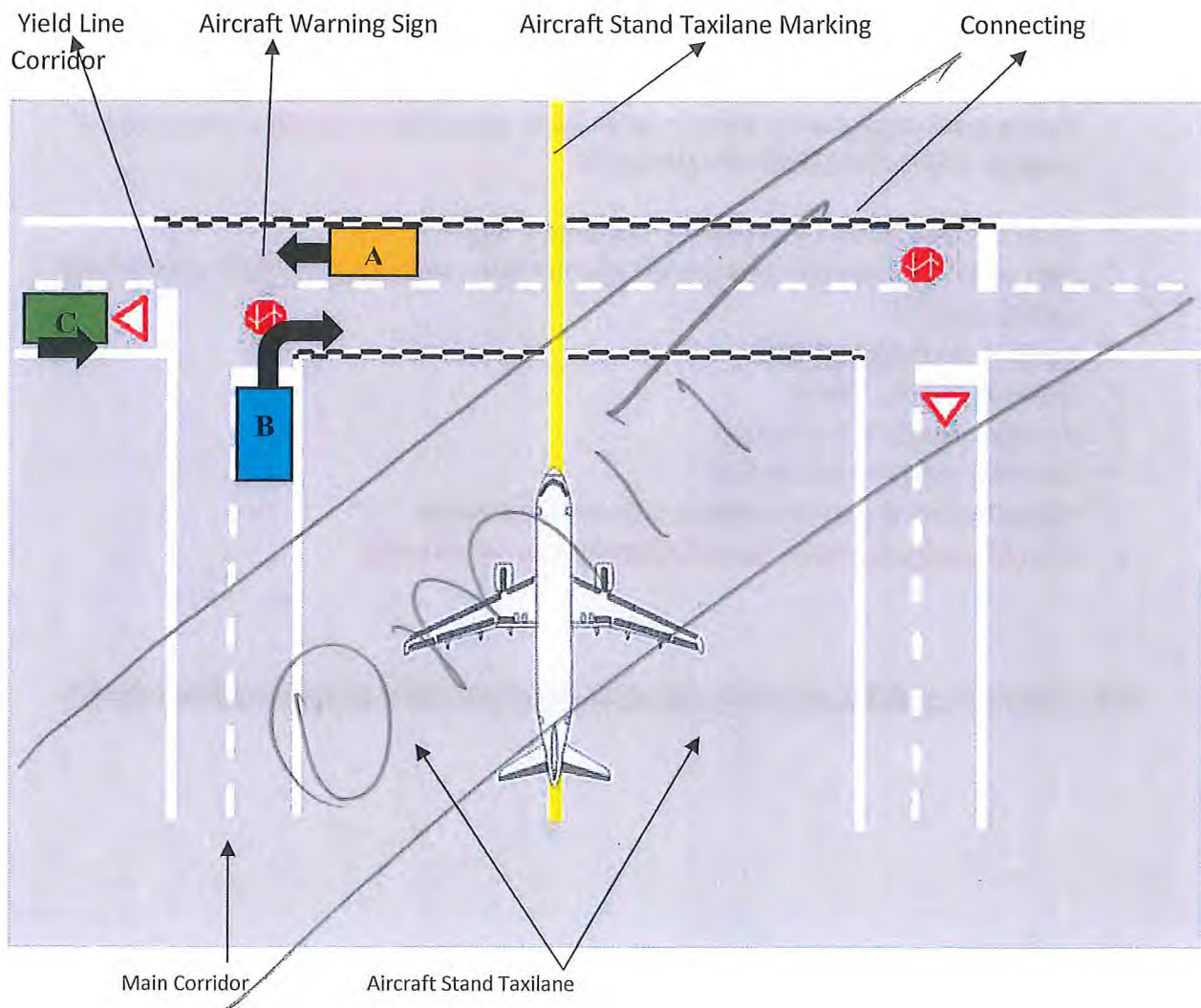

ATTN: ALL AIRSIDE STAFF

**IF YOU DRIVE AIRSIDE OVER TO THE TERMINAL
AREAS. PLEASE READ:**

**MANDATORY CHANGES TO AN
AVOP DIRECTIVE!**

SEE POSTING

WENT INTO EFFECT ON SEPT 20TH 2019

SINCERELY,



**AIR CANADA
CARGO**

Jasmin Goering

YYZ Airports/Cargo Trainer *Formateau- et Aeroports Fret*

C 416-999-8461

jasmin.goering@aircanada.ca



Advisory # 2019-09-10

Subject: Addition of Mandatory Stop Lines for vehicles driving on the apron

From: Aviation Services

Contact: AVOP Department, avop@gtaa.com, 416-776-2867(AVOP)

Date: 2019-09-10

Background

In 2015 the GTAA implemented changes pertaining to yielding of vehicles at intersections where two vehicle corridors are approaching a connecting corridor. *"At the intersection of any two connecting corridors or two main corridors, **the vehicle on the right has the right-of way.**"*

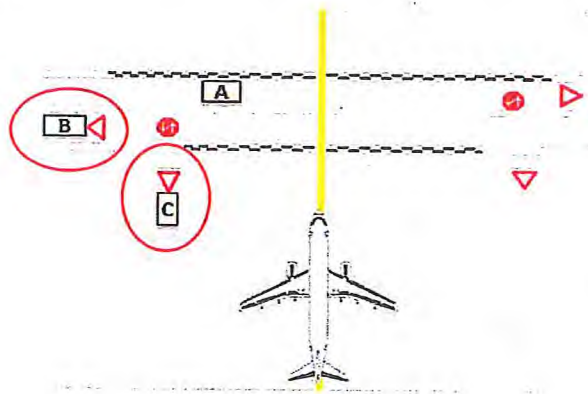

Fig 1.0

These rules were implemented in an effort to raise vehicle operator awareness of conflicting vehicular traffic when approaching the intersection of two main/connecting corridors.

In a continuous effort to improve vehicle operator awareness, vehicular traffic flow, and right of way at these intersections, a review was undertaken through the Safety Management System. These improvements will include an addition of **mandatory stop lines for all traffic leaving apron horsehoes** when joining with perpendicular vehicle corridors.

Operational Impact

Commencing September 20th 2019, Mandatory Vehicle Stop Bars will be installed at the intersection of any two connecting corridors or two main corridors.

This work is weather dependent and will be coordinated with the Apron Management Unit to minimize operational impact. The visuals below are provided as a quick reference tool.

Vehicle Mandatory Stop Bars



Figure 1

Vehicle stop bars to be added to all intersections of horseshoe corridors.

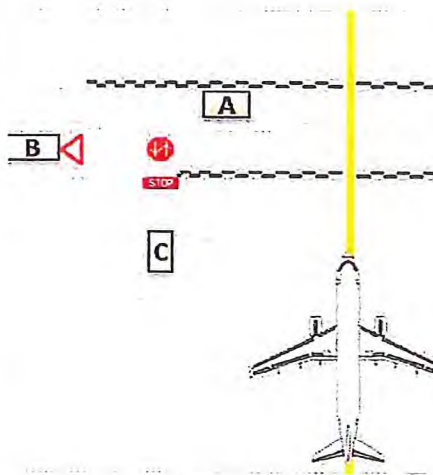
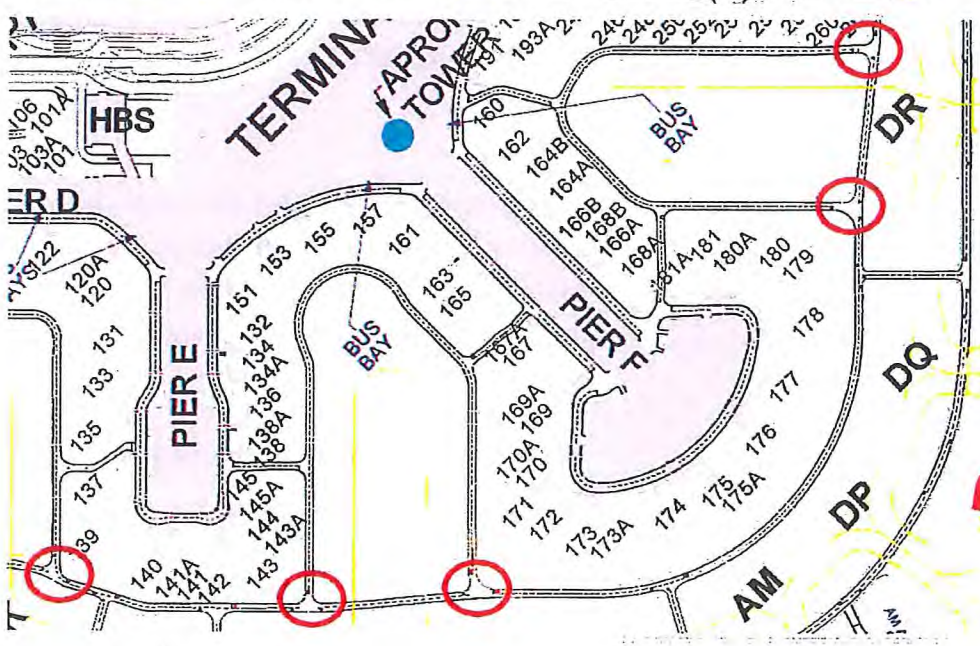
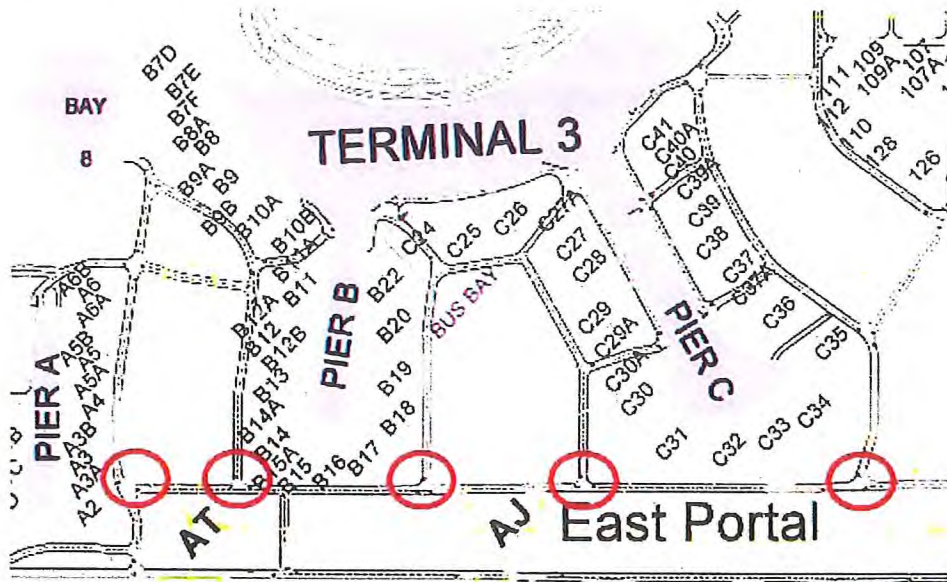

Figure 2

Vehicle stop bars indicating mandatory stop position for all vehicles within the corridors exiting apron horsehoes. Figure 2 indicates location of added stop bars including right-of-way priority which is as follows:

- 1) Vehicle A (connecting corridor)
- 2) Vehicle B
- 3) Vehicle C (required to stop at mandatory stop bar)

Locations Effected



AIRSIDE LIGHTING

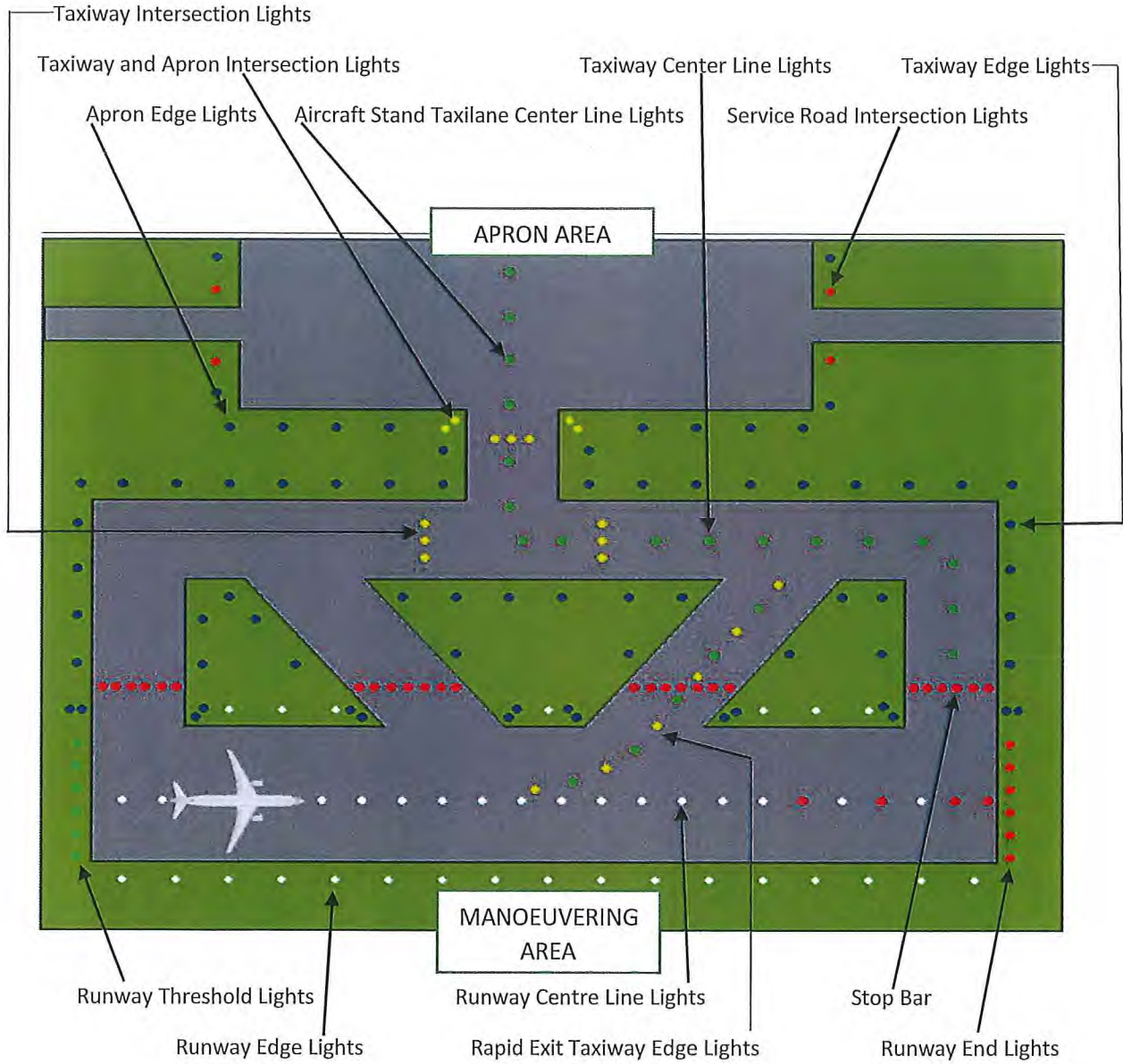

Apron Markings

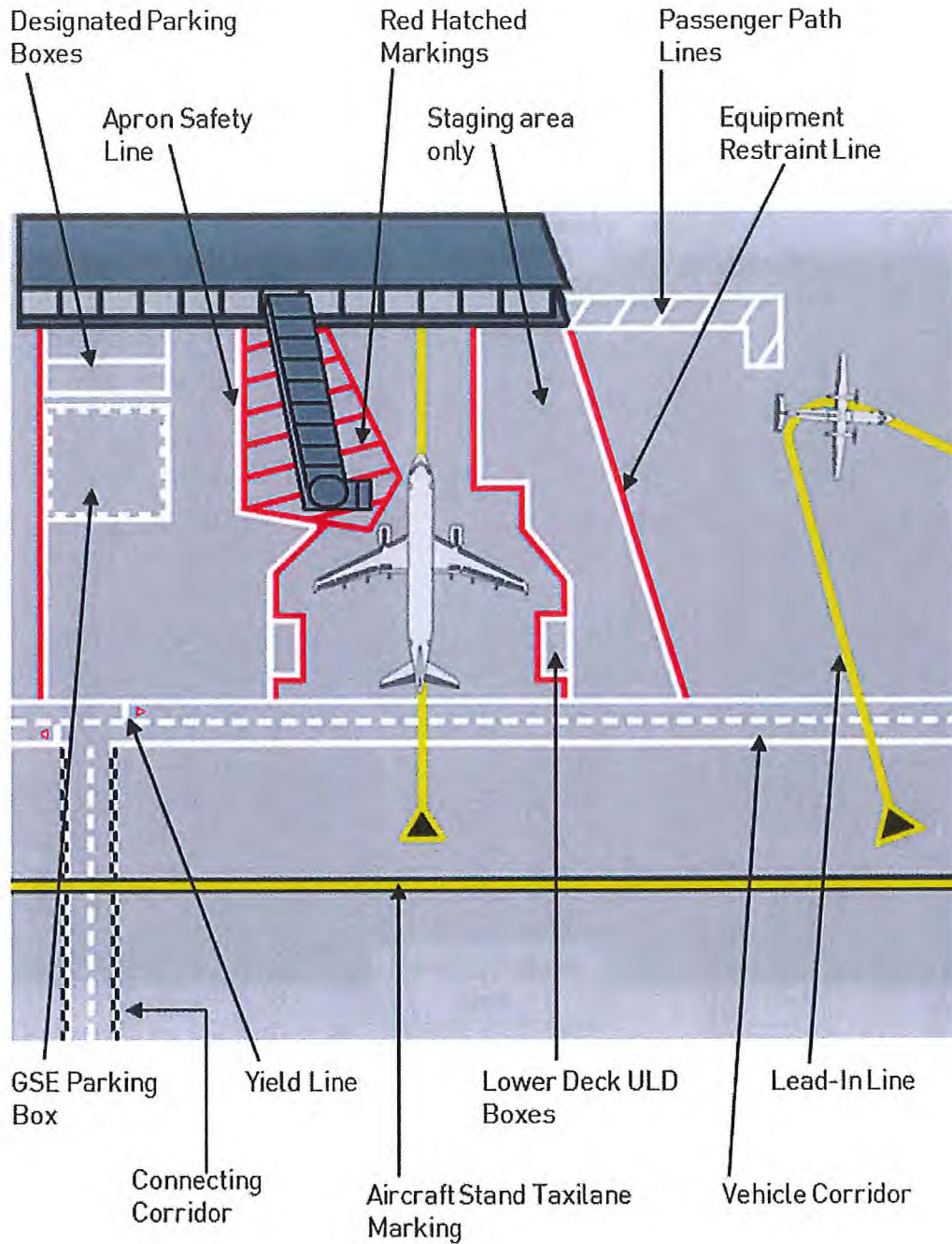

Airside Lighting

Taxiway and Apron Edge Lights:	Blue
Taxiway and Apron Centre Line Lights:	Green
Intersection of Taxiway and Apron:	Double Amber
Runway Edge Lights:	White
Runway Guard Lights or (Wig-Wags):	A pair of Amber flashing lights on either end of the taxiway at Hold positions.
Service Road Intersection Lights: (Intersecting with Apron, Taxiway or Runway)	Red
Obstruction Lights:	Red

Taxiway Markings

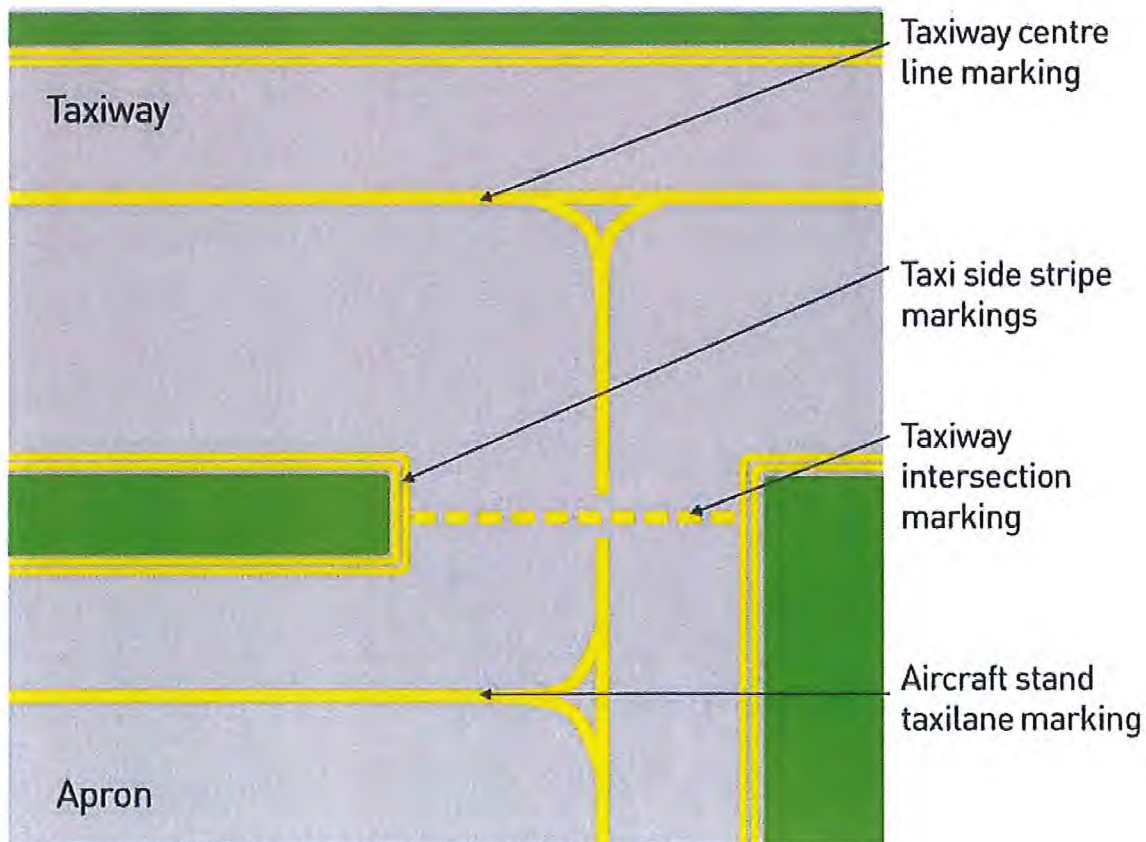

Taxiway markings appear as shown.

Airside Speed Limits

<i>Location</i>	<i>Speed Limit</i>	<i>Low Visibility</i>
Airside Service Roads	50km/h	25km/h
Within Vehicle Corridors	40km/h	20km/h
Infield Tunnel	50km/h	25km/h
Outside Vehicle Corridors (open Apron)	25km/h	12km/h
General Aviation North	25km/h	12km/h
Head of Stand Roads	20km/h	10km/h
Terminal Service Roads	10km/h	10km/h
Within 6m of a Parked Aircraft	10km/h	5km/h
Congested Areas	10km/h	5km/h

Reduce speed during poor weather conditions

Airside Lighting

- Taxiway and Apron Edge Lights: **Blue**
- Taxiway and Apron Centre Line Lights: **Green**
- Intersection of Taxiway and Apron: **Double Amber**
- Runway Edge Lights: **White**
- Runway Guard Lights or (Wig-Wags): **A pair of Amber flashing lights on either end of the taxiway at Hold positions.**
- Service Road Intersection Lights: **Red**
(Intersecting with Apron, Taxiway or Runway)
- Obstruction Lights: **Red**

Taxiway Markings

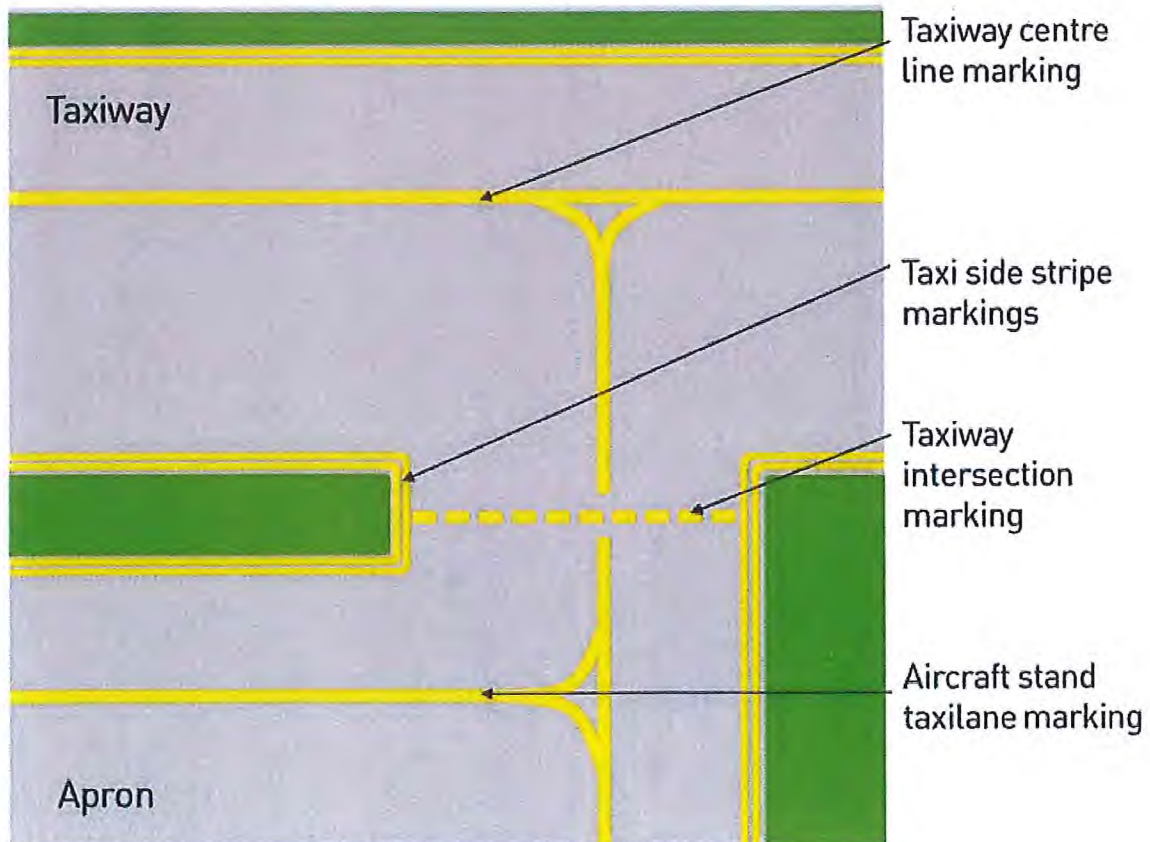

Taxiway markings appear as shown.

Airside Speed Limits

<i>Location</i>	<i>Speed Limit</i>	<i>Low Visibility</i>
Airside Service Roads	50km/h	25km/h
Within Vehicle Corridors	40km/h	20km/h
Infield Tunnel	50km/h	25km/h
Outside Vehicle Corridors (open Apron)	25km/h	12km/h
General Aviation North	25km/h	12km/h
Head of Stand Roads	20km/h	10km/h
Terminal Service Roads	10km/h	10km/h
Within 6m of a Parked Aircraft	10km/h	5km/h
Congested Areas	10km/h	5km/h

Reduce speed during poor weather conditions

Definitions Practice Test

Write the letter of the definition on the line beside the item it describes.
The first answer has been done as an example.

- | | | |
|-------------------------------------|---------------|---|
| 1. <i>Yield Lines</i> | <u> C </u> | A) Solid or broken yellow lines guiding aircraft to gates. |
| 2. <i>Aircraft Warning Sign</i> | <u> </u> | B) The portion of the airside used for the movement of aircraft. This portion is further divided into the Apron and Maneuvering Areas. |
| 3. <i>Airside Safety Officers</i> | <u> </u> | C) A white line 45cm wide across one lane of the vehicle corridor which identifying where drivers must yield to oncoming traffic. |
| 4. <i>Aircraft Lead-in Lines</i> | <u> </u> | D) Two solid yellow lines 15cm wide and 15cm apart, indicating the edge of aircraft load-bearing surfaces. |
| 5. <i>Movement Area</i> | <u> </u> | E) The GTAA personnel primarily responsible for enforcing the AVOP program. |
| 6. <i>Taxi Side Stripe Markings</i> | <u> </u> | F) A symbol indicating the direction of aircraft travel which is placed in vehicle corridors to alert drivers that they are about to cross a live aircraft stand taxilane and to be extra vigilant. |

Multiple Choice Practice Test

Tips for multiple choice questions:

- Circle the most accurate answer
 - Read the question carefully. Read all of the answers before making your choice. Some questions may have more than one correct answer. (For example, the correct response may be "all of the above")
 - If you are not sure of the correct answer, narrow down your choices by eliminating answers that you know are incorrect
 - When you complete the test, go back and check your work
-

1. What markings identify a safe path for passengers walking from the terminal to an aircraft parked on the apron?
 - A) Red hatched markings
 - B) Apron safety lines
 - C) Aircraft lead-in lines
 - D) Passenger path lines

2. The Infield Tunnel is divided into two sections. What are they called?
 - A) The East Cell and the West Cell
 - B) The North Cell and the South Cell
 - C) Lane 1 and Lane 2
 - D) None of the above

3. What is the speed limit in the Infield Tunnel?
 - A) 20 km/h
 - B) 60 km/h
 - C) 50 km/h
 - D) 40 km/h

4. Marshalling crews shall be given the same priority as:
 - A) Emergency vehicles responding to an emergency
 - B) Aircraft
 - C) Passenger Transfer Vehicles
 - D) None of the above

5. Yellow lines painted on the apron pertain to:
 - A) vehicles
 - B) aircraft
 - C) both vehicles and aircraft
 - D) there are no yellow lines painted on the apron

6. What is the speed limit within a vehicle corridor?
- A) 5 km/h
 - B) 10 km/h
 - C) 25 km/h
 - D) 40 km/h
7. Vehicle operators encountering electrical power cables, fuel hoses, etc., shall:
- A) not cross over them
 - B) cross over them slowly
 - C) cross over them at a 90-degree angle
 - D) move them out of the way
8. Vehicle operators must use the vehicle corridors when:
- A) transiting more than one gate
 - B) transiting between terminals
 - C) moving across aircraft stand taxilanes
 - D) all of the above
9. What is the speed limit within 6m (20 feet) of an aircraft?
- A) 5 km/h
 - B) 10 km/h
 - C) 15 km/h
 - D) 25 km/h
10. What colour are runway edge lights?
- A) blue
 - B) white
 - C) amber
 - D) red
11. What is the indication to ramp personnel that the airport is in the Low Visibility Operations Phase?
- A) blue beacons will be activated at security booths around the airport
 - B) White strobe lights on the terminal buildings may be activated
 - C) blue beacons will be activated on vehicles so equipped
 - D) both A and C
12. The maximum number of pallet dollies that can be towed at one time is:
- A) 3
 - B) 4
 - C) 5
 - D) 6
13. What colour are taxiway edge lights and apron edge lights?
- A) blue
 - B) white
 - C) amber
 - D) red

14. Whose responsibility is it to remove FOD?
- A) your supervisor
 - B) GTAA Airside Safety Officers
 - C) all airside personnel
 - D) GTAA field maintenance
15. What is the speed limit on airside service roads?
- A) 25 km/h
 - B) 40 km/h
 - C) 50 km/h
 - D) 60 km/h
16. The maximum number of baggage carts that can be towed at one time is:
- A) 3
 - B) 4
 - C) 5
 - D) 6
17. Drivers are permitted to pass slow moving equipment when:
- A) The section of the vehicle corridor immediately in front of the vehicle being passed is clear
 - B) The vehicle being passed is traveling less than 15 km/h
 - C) The applicable speed limit is not exceeded to accomplish the pass
 - D) All of the above
18. What colour are the lights that indicate the intersection of a taxiway and an apron?
- A) double amber
 - B) double red
 - C) single white
 - D) single blue
19. What action are you required to take when you encounter an emergency vehicle displaying flashing red lights, driving towards you on the apron?
- A) immediately turn to the right and drive toward the terminal
 - B) turn around and drive in the direction of the responding vehicle
 - C) slow down and come to a safe stop
 - D) return to your starting point in the airport
20. What is the speed limit on Head of Stand roads?
- A) 15 km/h
 - B) 20 km/h
 - C) 30 km/h
 - D) 40 km/h

Apron Entrances

From Left to Right

Taxiway ALPHA

AD – Did
AE – Eight
AF – Frogs
AG – Get
AT – To
AJ – Jump
AK – K
AL – L
AM – M

Taxiway DELTA

DP – Paul
DQ – Quickly
DR – Ran
DT – To
DV – Vic

Taxiway ECHO

EY – Youth
EB – Before
EA – Age

Taxiway JULIETTE

JD – feD
JE – Ex

MAP QUIZ

- 1) ____ TAXIWAY DELTA
- 2) ____ APRON ENT/EXIT EA
- 3) ____ TAXIWAY ALPHA
- 4) ____ APRON ENT/EXIT AL
- 5) ____ TAXIWAY JULIETTE
- 6) ____ APRON ENT/EXIT DR
- 7) ____ TERMINAL 3
- 8) ____ APRON ENT/EXIT DP
- 9) ____ TERMINAL 3 SATELLITE
- 10) ____ AIR TRAFFIC CONTROL TOWER
- 11) ____ TAXIWAY ECHO
- 12) ____ APRON ENT/EXIT AM
- 13) ____ CENTRAL DEICING FACILITY (CDF)
- 14) ____ APRON ENT/EXIT AD
- 15) ____ APRON ENT/EXIT AG
- 16) ____ TERMINAL 1
- 17) ____ APRON ENT/EXIT AT
- 18) ____ APRON ENT/EXIT DV
- 19) ____ APRON ENT/EXIT DT
- 20) ____ INFIELD TERMINAL (IFT)
- 21) ____ APRON ENT/EXIT AK
- 22) ____ INFIELD/CARGO WEST APRON
- 23) ____ APRON ENT/EXIT AF
- 24) ____ APRON ENT/EXIT AJ
- 25) ____ THREE BAY HANGAR
- 26) ____ APRON ENT/EXIT AE
- 27) ____ NORTH FIREHALL
- 28) ____ APRON ENT/EXIT EY
- 29) ____ APRON ENT/EXIT JE
- 30) ____ INFIELD TUNNEL
- 31) ____ APRON ENT/EXIT JD
- 32) ____ FED EX
- 33) ____ SOUTH FIREHALL
- 34) ____ APRON ENT/EXIT EB
- 35) ____ GENERAL AVIATION NORTH
- 36) ____ VISTA CARGO
- 37) ____ APRON ENT/EXIT DQ
- 38) ____ SOUTH SERVICE ROAD
- 39) ____ NORTH SERVICE ROAD

PRACTISE MAP

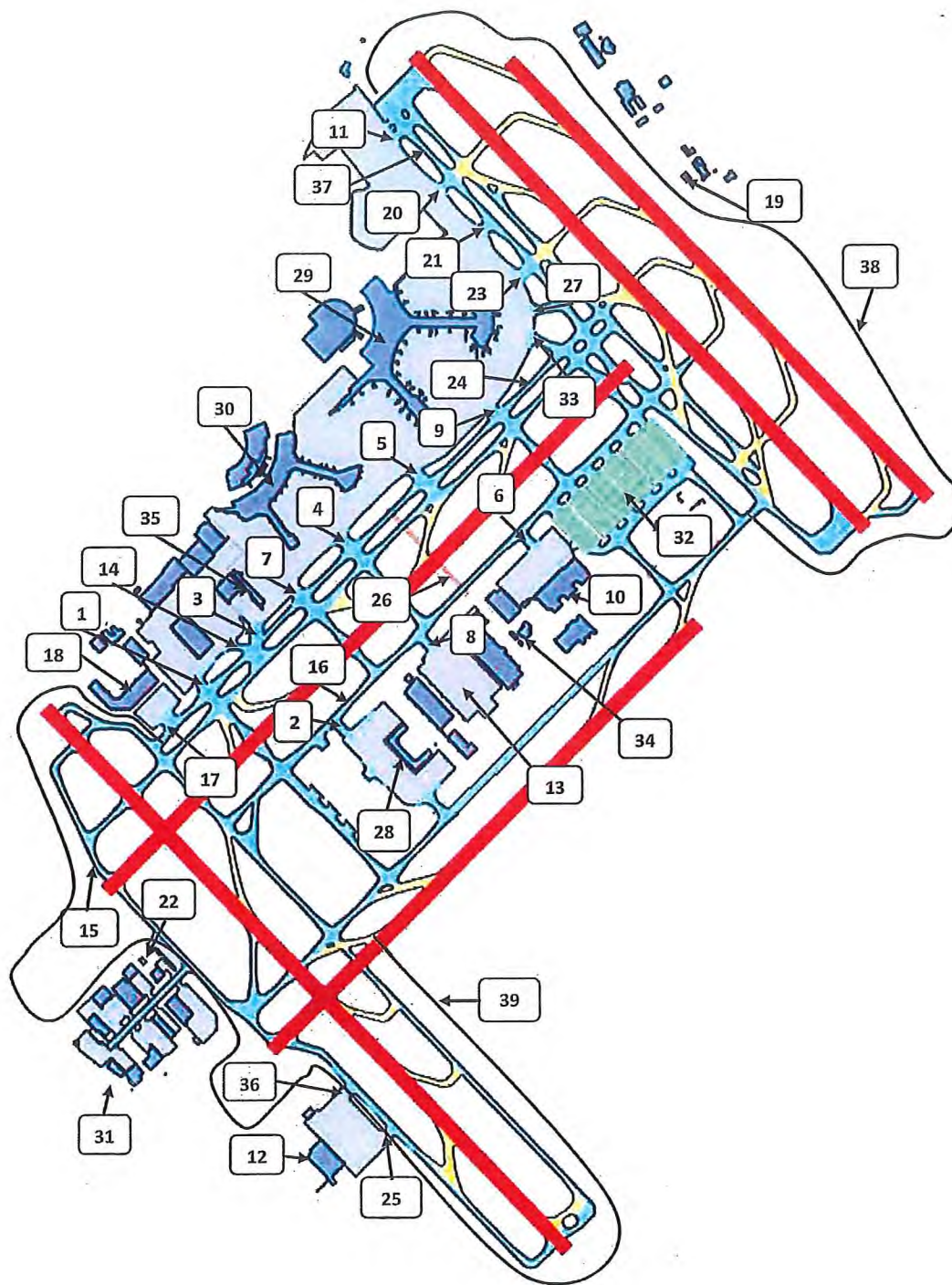

ANSWERS TO MAP QUIZ

- 1) 37
- 2) 6
- 3) 24
- 4) 9
- 5) 15
- 6) 21
- 7) 30
- 8) 27
- 9) 35
- 10) 34
- 11) 16
- 12) 33
- 13) 32
- 14) 17
- 15) 3
- 16) 29
- 17) 7
- 18) 11
- 19) 20
- 20) 28

- 21) 5
- 22) 13
- 23) 14
- 24) 4
- 25) 10
- 26) 1
- 27) 22
- 28) 2
- 29) 36
- 30) 26
- 31) 25
- 32) 12
- 33) 19
- 34) 8
- 35) 31
- 36) 18
- 37) 23
- 38) 38
- 39) 39

Definitions Practice Test Answers

1. C
2. F
3. E
4. A
5. B
6. D

Multiple Choice Practice Test Answers

1. D
2. B
3. C
4. B
5. B
6. D
7. A
8. D
9. B
10. B
11. D
12. B
13. A
14. C
15. C
16. D
17. D
18. A
19. C
20. B

